



enduro



BUILDING PRODUCTS
TUFF SPAN™

FRP BUILDING PRODUCTS

- Roofing and Siding
- Structural Shapes
- Roof Deck
- Form Deck
- Louvers
- Ridge Vents
- Gutter
- Buildings

www.endurocomposites.com

ENDURO COMPOSITES & TUFF SPAN™

For demanding conditions, **Tuff Span™** FRP building panels, beams, ventilation and gutter system is The Proven Solution. Delivering outstanding performance and important benefits, Tuff Span from Enduro is the global leader for glass Fiber Reinforced Plastic (FRP) building products.



Corrosion Resistance



Superior Strength



Life Cycle Cost Savings



Maintenance Free



FRP ROOFING & SIDING PANELS

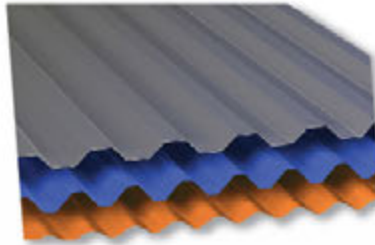

With unsurpassed combination of corrosion resistance, strength and UV protection, **Tuff Span™** is the optimum cladding panel for challenging, tough conditions.

- Opaque or Translucent Panels
- Strongest FRP Building Panels
- Single Skin or Insulated
- FM & UL Certifications
- Walkable Roof Panels
- Superior UV Protection
- Wide Range of Profiles

FRP ROOF DECK

With outstanding corrosion resistance, **Tuff Span™** Fiberglass Reinforced Plastic Roof Deck provides long term structural support for single ply membrane and built up roofing materials.



- Superior to Metal or Wood Roof Deck
- Does Not Rust, Rot, Peel, or Flake
- Resists Creep under Dead Load

PROVEN UNDER THE TOUGHEST CONDITIONS



At a power plant on the Florida coast, Tuff Span roofing and siding (on end wall) was undamaged by Hurricane Charley's 145 mph winds. Corroded metal panels (on side wall) were damaged or blown off.

FRP STRUCTURAL SHAPES

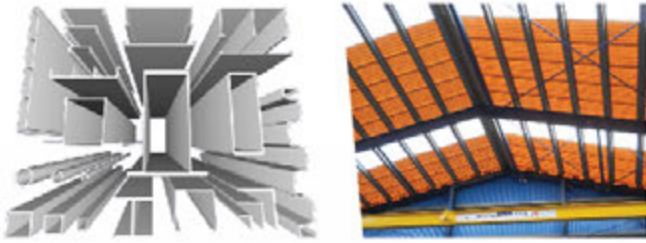

By innovative use of shape, glass fiber reinforcing, and manufacturing process, **Tuff Span™** Flanged Tube Beams are designed for long spans and heavy loads. Corrosion resistant, standard shapes include FRP flat plate, angle, tube, and wide flange sections.

- Primary Framing Members
- Roof Purlins and Wall Girts
- Complete Line of Shapes

FRP LOUVERS\ RIDGE VENTS



Tuff Span™ fiberglass reinforced plastic louvers and ridge vents provide air flow for industrial facilities and compliment FRP roofing and siding panels.

- Strong & Durable
- Fixed or Adjustable Openings
- Size & Color Options

FRP FORM DECK

Steel form deck and reinforcing bars, and slabs are vulnerable to chemical exposure. For these conditions, **Tuff Span™** FRP Form Deck provides a permanent form and corrosion protection for the underside of slabs.



- Reliable Support for Wet Concrete
- Permanent Form for Concrete
- Improved Plant Safety

FRP GUTTERS

Tuff Span™ gutter and downspout provides moisture drainage at industrial facilities. Eliminating the need for hangers and brackets, a continuously-hinged flange pivots to fit any roof pitch.



- Corrosion Resistant
- Adjustable Mounting Flange
- Complete System w/Accessories

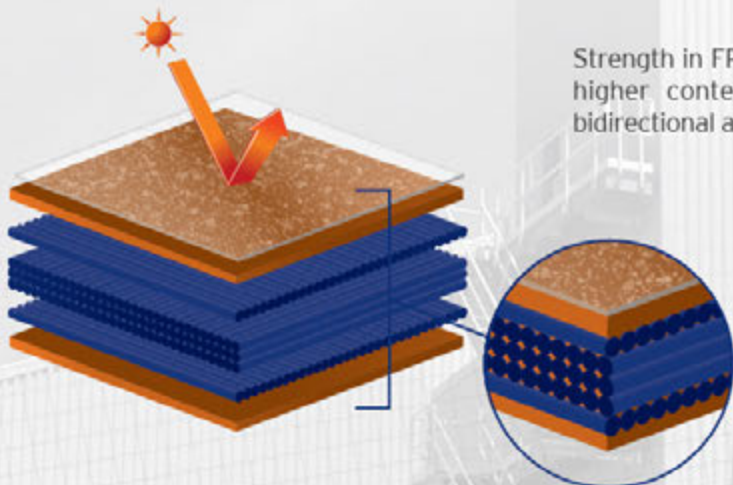

Strength in FRP is controlled by its reinforcing content and alignment. With higher content of continuous glass fiber reinforcements in straight, bidirectional alignment, Tuff Span is the strongest profiled FRP building panel.

- UV acrylic polymer coating protection
- Corrosion resistant UV stabilized, fire retardant resin system
- Continuous, straight bidirectional reinforcements (3 layers)

APPLICATIONS

- Aluminum
- Chemical
- Cement
- Cooling Towers
- Corn Processing
- Desalination
- Electronics
- Fertilizer
- Food and Beverage
- Galvanizing/Plating
- Metal Processing
- Marine/Port Facilities
- Mining
- Military
- Natatoriums
- Pulp and Paper
- Power
- Rendering
- Salt
- Textile
- Waste Treatment

enduro

www.endurocomposites.com



HOUSTON HEADQUARTERS

16602 Central Green Blvd.
Houston, TX 77032

Office 713.358.4000

Toll Free 800.231.7271

Fax 713.358.4100

bpsales@endurocomposites.com

