

Channel Framing (Solid & Punched)

Part No.	Lbs./Ft.
Polyester: EC-10	0.47
Vinyl Ester: EC-VE-10	

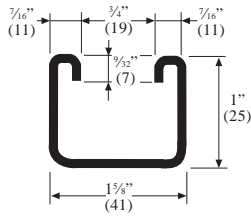

Part No.	Lbs./Ft.
Polyester: EC-158	0.68
Vinyl Ester: EC-VE-158	

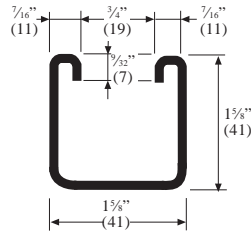

Part No.	Lbs./Ft.
Polyester: EC-158D	1.36
Vinyl Ester: EC-VE-158D	

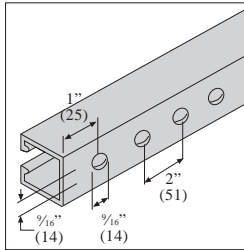
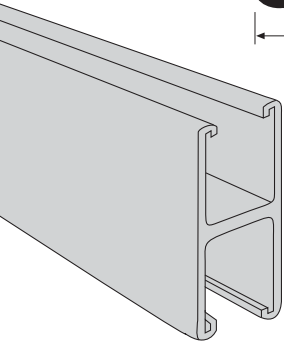
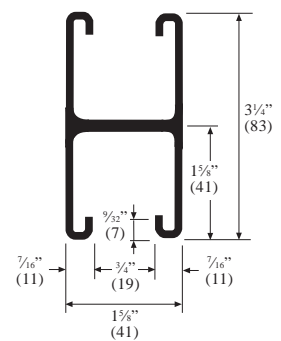

For punched channel framing add "H" to the end of the part number; example: EC-10H. Punched not available for double channel. Punched holes are 9/16" holes on 2" centers. Replaces drilled strut.

For use in tray support systems, electrical conduit and tray rungs for tying down cable. Available in 10 ft and 20 ft lengths. See below for loading, and see page 38 for specification information.

Technical Data - Support Systems & Strut

Channel Framing Loading

Beam and Column Data: Polyester and Vinyl Ester Resin Base

Beam Span or Column Height In.(mm)	Part No.	Maximum Allowable Uniform Beam Load		Deflection @ Maximum Allowable Uniform Beam Load		Uniform Load @ Maximum Deflection = 0.25 In. (6mm)		Uniform Load @ Maximum Deflection = 0.50 In. (13mm)		Maximum Allowable Column Load Lbs.(kg)
		Poly Lbs.(kg)	Vinyl Lbs.(kg)	Poly In.(mm)	Vinyl In.(mm)	Poly Lbs.(kg)	Vinyl Lbs.(kg)	Poly Lbs.(kg)	Vinyl Lbs.(kg)	
12" (305)	EC-10	790 (358)	990 (449)	0.11 (3)	0.12 (3)	-	-	-	-	2550 (1156)
	EC-158	1720 (780)	2150 (975)	0.07 (2)	0.07 (2)	-	-	-	-	3650 (1655)
	EC-158D	5080 (2301)	6350 (2880)	0.04 (1)	0.04 (1)	-	-	-	-	7300 (3311)
18" (457)	EC-10	530 (240)	670 (304)	0.24 (6)	0.27 (7)	-	620 (281)	-	-	2350 (1066)
	EC-158	1150 (521)	1440 (653)	0.15 (4)	0.17 (4)	-	-	-	-	3370 (1528)
	EC-158D	5080 (2301)	4240 (1923)	0.09 (2)	0.10 (2)	-	-	-	-	6740 (3058)
24" (610)	EC-10	400 (181)	500 (227)	0.43 (11)	0.48 (12)	240 (109)	270 (122)	-	-	2070 (939)
	EC-158	860 (390)	1080 (490)	0.27 (7)	0.30 (8)	810 (367)	910 (412)	-	-	2960 (1342)
	EC-158D	2540 (1152)	3180 (1442)	0.16 (4)	0.17 (4)	-	-	-	-	5920 (2685)
30" (762)	EC-10	320 (145)	400 (181)	0.67 (17)	0.75 (19)	120 (54)	140 (63)	240 (109)	270 (122)	1710 (775)
	EC-158	690 (313)	870 (394)	0.42 (11)	0.48 (12)	410 (186)	460 (209)	-	-	2450 (1111)
	EC-158D	2040 (925)	2550 (1156)	0.24 (6)	0.27 (7)	2000 (907)	2350 (1066)	-	-	4900 (2222)
36" (914)	EC-10	270 (122)	340 (154)	0.98 (25)	1.10 (28)	70 (31)	80 (36)	140 (63)	160 (72)	1260 (571)
	EC-158	580 (263)	730 (331)	0.61 (15)	0.69 (19)	240 (109)	270 (122)	480 (217)	540 (245)	1800 (816)
	EC-158D	1700 (771)	2130 (966)	0.35 (9)	0.39 (10)	1220 (553)	1370 (621)	-	-	3600 (1633)
42" (1067)	EC-10	230 (104)	290 (131)	1.32 (34)	1.49 (38)	50 (22)	55 (25)	100 (45)	115 (52)	920 (417)
	EC-158	490 (222)	620 (281)	0.82 (21)	0.92 (23)	150 (68)	170 (77)	300 (136)	340 (154)	1320 (598)
	EC-158D	1460 (662)	1830 (830)	0.48 (12)	0.62 (16)	770 (349)	870 (394)	1510 (650)	1720 (530)	2640 (1197)
48" (1219)	EC-10	200 (91)	250 (113)	1.72 (44)	1.92 (49)	30 (13)	25 (16)	60 (27)	70 (31)	700 (317)
	EC-158	430 (195)	540 (245)	1.07 (27)	1.20 (30)	100 (45)	115 (52)	200 (90)	230 (104)	1010 (458)
	EC-158D	1270 (576)	1590 (721)	0.62 (16)	0.69 (17)	520 (236)	590 (267)	1040 (471)	1170 (780)	2020 (916)
60" (1524)	EC-10	160 (72)	200 (91)	2.68 (68)	2.99 (76)	20 (9)	23 (10)	40 (18)	45 (20)	180 (81)
	EC-158	350 (158)	400 (200)	1.70 (43)	1.91 (48)	60 (27)	70 (32)	120 (54)	135 (61)	260 (118)
	EC-158D	1020 (462)	1280 (580)	0.97 (25)	1.09 (28)	270 (122)	310 (140)	540 (245)	610 (276)	520 (235)
72" (1829)	EC-10	140 (63)	180 (81)	*	*	10 (4)	12 (5)	20 (9)	23 (10)	-
	EC-158	290 (131)	370 (168)	2.44 (62)	2.78 (71)	30 (13)	34 (15)	60 (27)	70 (32)	-
	EC-158D	850 (385)	1070 (485)	1.40 (35)	1.57 (40)	160 (72)	180 (81)	320 (145)	360 (163)	-
84" (2134)	EC-10	120 (54)	150 (68)	*	*	NR	-	12 (5)	15 (7)	-
	EC-158	250 (113)	320 (145)	*	*	20 (9)	23 (10)	40 (18)	45 (20)	-
	EC-158D	730 (331)	920 (417)	1.91 (48)	2.15 (55)	100 (45)	115 (52)	200 (90)	230 (104)	-
96" (2438)	EC-10	100 (45)	130 (59)	*	*	NR	-	-	-	-
	EC-158	220 (100)	250 (113)	*	*	13 (6)	15 (7)	26 (12)	30 (13)	-
	EC-158D	640 (290)	800 (363)	2.50 (63)	2.79 (71)	70 (32)	80 (36)	140 (63)	160 (72)	-

* Deflection is in excess of 3.00 In. (76mm); mid-span support is recommended. NR = Not Recommended; **Beam Loads:** Table lists the total allowable load for various simple spans based on a minimum safety factor 2:1. If load is concentrated at center of span, multiply the load from the table by 0.5 and the corresponding deflection by 0.8. **Column Loads:** Table lists the total allowable axial load for various unsupported column heights based on a minimum safety factor of 3:1. Eccentric loads should be reduced according to standard practice.

Notes: All beams should be supported in a manner to prevent rotation at supports. Long, deep beams should be tied between supports to prevent twist.

Support Systems & Strut

Connector Plates

Based on individual applications, changes may be required on dimension and thickness of material. Please contact us. Holes are drilled to accept $\frac{3}{8}$ " and $\frac{1}{2}$ " bolts. For Vinyl Ester Connector Plates, insert the letters "VE" as indicated in this example: Polyester = CP-100; Vinyl Ester = CP-VE-100

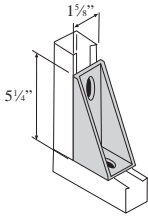

Universal Angle

Part No.
Polyester: CP-501
Polyurethane: CP-PU-501
Nylon: CP-NY-501

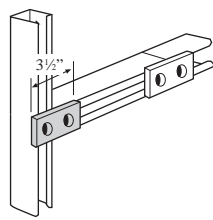

Part No.
CP-100

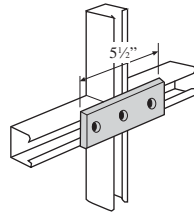

Part No.
CP-101

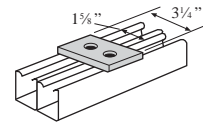

Part No.
CP-102

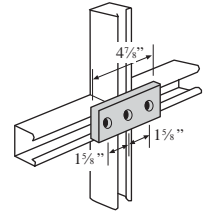

Part No.
CP-103

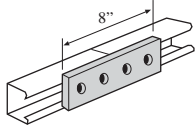

Part No.
CP-104

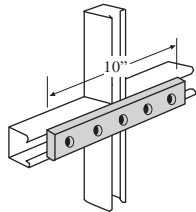

Part No.
CP-105

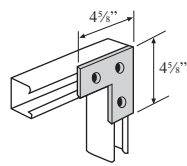

Part No.
CP-109

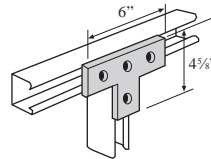

Part No.
CP-110

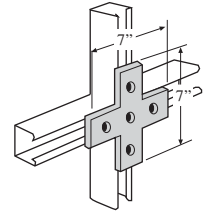

Part No.
CP-111

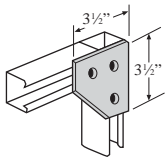

Part No.
CP-112

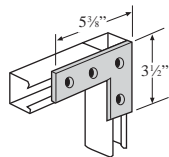

Part No.
CP-113

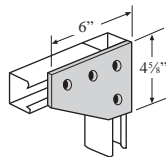

Part No.
CP-114

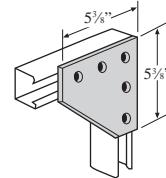

Part No.
CP-115

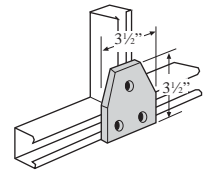

Part No.
CP-116

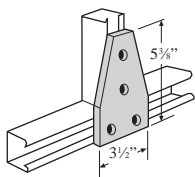

Part No.
CP-117

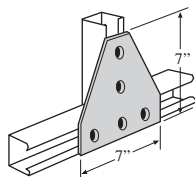

Part No.
CP-118

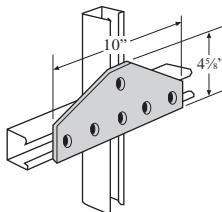

Part No.
CP-119

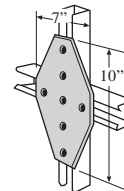

Part No.
CP-120

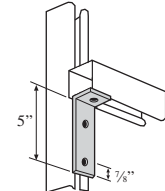

Note: Flat washer not required for CP-205

Part No.
CP-205

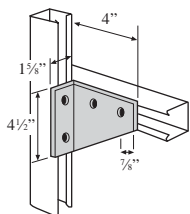

Part No.
CP-209

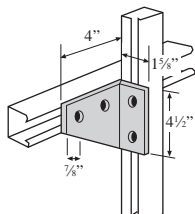

Part No.
CP-210

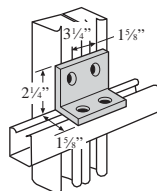

Part No.
CP-211

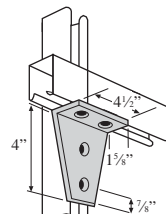

Part No.
CP-226

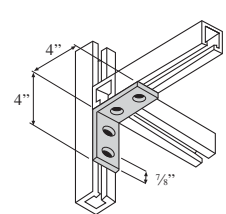

Part No.
CP-405

Support Systems

Post Base

Part No.
Polyester: PBD-PE
Polyurethane: PBD-PU

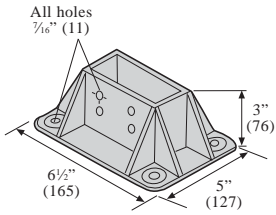

Part No.
Polyester: PBS-PE
Polyurethane: PBS-PU

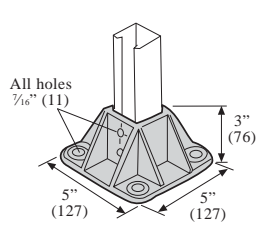

Part No.
Vinyl Ester: PB-1V

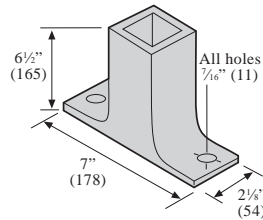

Window Clamp

Part No.
WC-158
Stainless steel set screw included

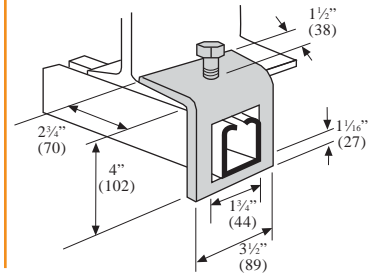

Fiberglass Clevis Hanger

Part No.	Nominal Dia. In.	Dimension In.			Hanger Rod In.	Allowable Load Lbs.
		A	B	C		
CH-010	1	1 3/8	4 3/4	3	1/2	200
CH-015	1 1/2	2 3/8	5 5/8	3 3/8	1/2	200
CH-020	2	2 1/2	7	4 3/8	1/2	200
CH-025	2 1/2	3 5/16	6 1/16	4 1/4	1/2	200
CH-030	3	3 3/4	7 1/2	4 1/4	1/2	300
CH-040	4	5 1/8	9 3/4	5 7/8	1/2	400
CH-060	6	7 3/16	12 3/8	8	1/2	600
CH-080	8	9 3/8	15 1/16	10 1/4	1/2	600
CH-100	10	11 19/32	14 7/8	12 11/16	5/8	600
CH-120	12	13 3/8	22 1/4	14	5/8	600
CH-140	14	15 1/4	26 3/16	16 3/4	5/8	600

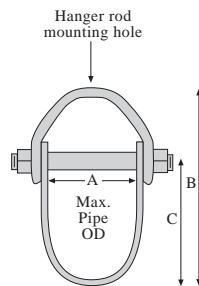

Vinyl Ester resin is the standard. Allowable loads have a 3:1 safety factor at 120°F. Insulation may be required at higher temperatures. Tolerance is 1/4" maximum.

FRP Channel Nut

Part No.	Size	Weight	t
CN-038	3/8"-16	5.46 Lbs/C	1 1/16" (27)
CN-050	1/2"-13	5.00 Lbs/C	1 1/16" (27)

Vinyl Ester resin is the standard. Channel nuts are self locking and designed for use with EC-158 and EC-158SD strut only.

Resistance to slip = 450 Lbs. per bolt
Pull out strength = 700 Lbs. per bolt
Recommended safety factor = 3

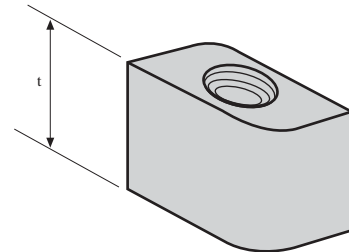
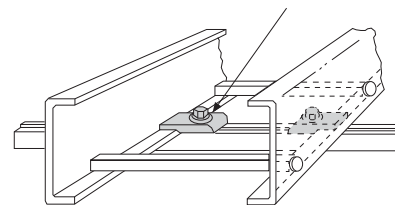
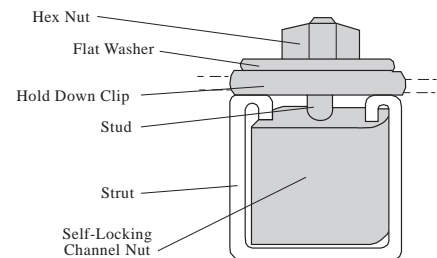

Diagram: FRP Channel Nut with Hold Down Clip



Non-Metallic Universal Pipe Clamp

Conduit Outside Diameter Inches
(for reference only)

Part No.	Pipe Size Inches	Wt./ 100 Sets* Lbs.	PVC Schedule 40 & 80	PVC Coated Steel	Rigid Steel	Fiberglass (FRP)
PC-1609N	1/2	9.0	0.840	0.920	0.840	-
PC-1610N	3/4	10.0	1.050	1.130	1.050	0.890
PC-1611N	1	10.5	1.315	1.395	1.315	1.195
PC-1612N	1 1/4	11.0	1.660	1.740	1.660	1.507
PC-1613N	1 1/2	13.0	1.900	1.980	1.900	1.757
PC-1614N	2	14.0	2.375	2.455	2.375	2.132
PC-1615N	2 1/2	18.0	2.875	2.955	2.875	2.650
PC-1616N	3	20.0	3.500	3.580	3.500	3.132
PC-1617N	3 1/2	23.0	4.000	4.080	4.000	3.632
PC-1618N	4	25.0	4.500	4.580	4.500	4.132

* Includes nylon bolt

For rigid, PVC coated steel, PVC Schedule 40 & 80 and fiberglass conduit.

Made from a toughened grade of glass reinforced thermoplastic polyester resin. Standard fasteners are nylon slotted hex bolt and nut. Recommended for horizontal use as shown. For vertical placement please contact us.

Packaged twenty sets per bag.

If stainless steel fasteners are preferred, indicate by adding the letter "S" after the catalog number (Example: PC-1609S).

